

CITY OF CHESTERMERE

PROVINCE OF ALBERTA

BYLAW #008-17

A Bylaw of the City of Chestermere, in the Province of Alberta, to amend the Land Use Bylaw (Bylaw 008-17) of the City of Chestermere.

WHEREAS The Municipal Government Act, RSA 2000, C. M-26 and amendments thereto provides that a Municipal Council must pass a Land Use Bylaw;

AND WHEREAS Council deems it desirable to amend Bylaw 008-17 to allow the development of portions of NE 4-24-28-4 and NW 4-24-28-4

NOW THEREFORE, The Council of the City of Chestermere, duly assembled, enacts as follows:

1. That Schedule "A – Land Use District Map" of the Land Use Bylaw 022-10 be amended by redesignating portions of Portions of NE 4-24-28-4 and NW 4-24-28-4 from Urban Transition District (UT) to Residential Single Detached District (R-1); Residential Semi Detached (R-2); Residential Single Detached Planned Lot (R-1P); Residential Multi-Unit District (R-3); Low Rise Residential Multi-Unit District (R-4); Public Service (PS); Public Services District (PS); Local Commercial District (C); and Direct Control Back-to-Back Townhouses as shown on attached Schedule 'A' attached to and forming part of this Bylaw.
2. That Schedule "B – Waterford Stage 1 Outline Plan" be adopted as shown on attached Schedule 'B' attached to and forming part of this Bylaw.
3. This Bylaw comes into full force and takes effect on the date of third and final reading.

READ A FIRST TIME this ____ day of _____.

READ A SECOND TIME this ____ day of _____.

READ A THIRD TIME this ____ day of _____.

Resolution Numbers –



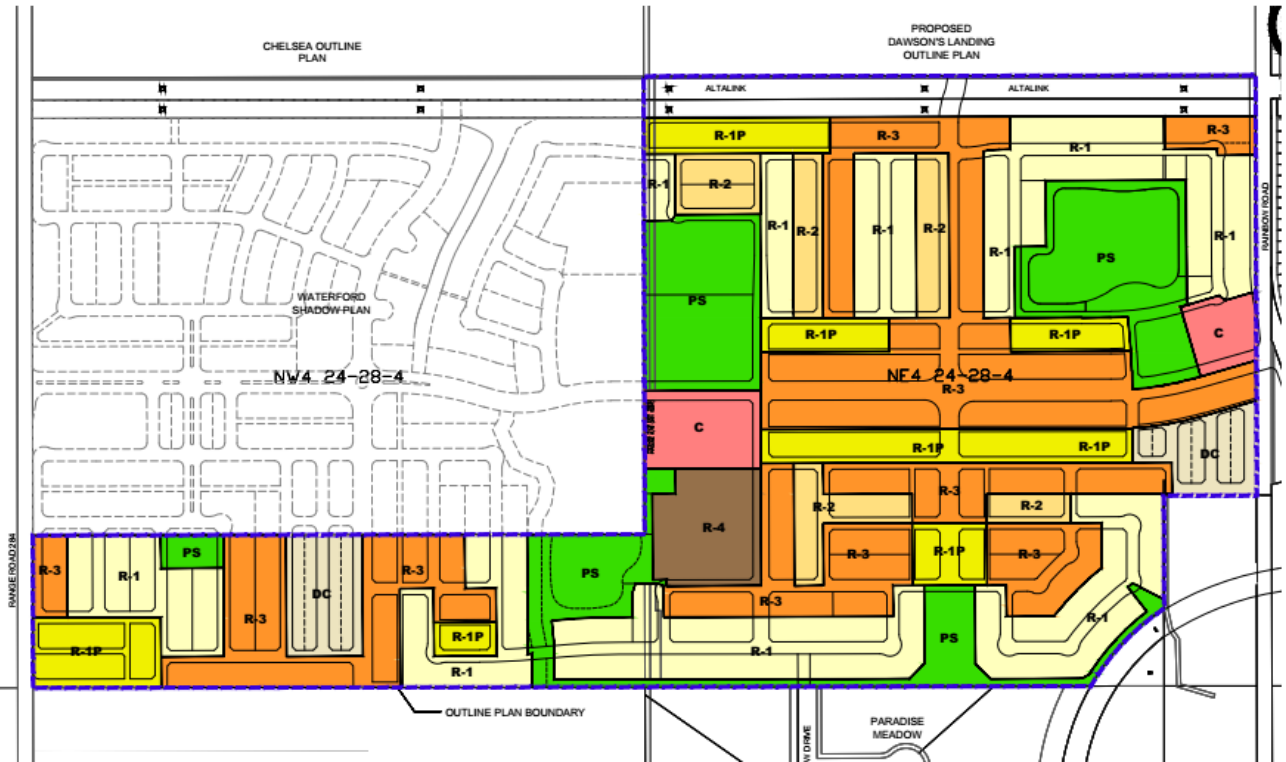

MAYOR

CAO

CITY OF CHESTERMERE

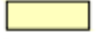

Legend

-  Waterford OP Boundary
-  R-1
-  R-1P
-  R-2
-  R-3

-  C
-  PS



BYLAW 008-17 LAND USE BYLAW AMENDMENT Schedule "A"