

TOWN OF CHESTERMERE

POLICY HANDBOOK

EFFECTIVE DATE: June 16 th , 2003	SECTION: 300 POLICY: 305
APPROVED BY: COUNCIL	SUBJECT: Collector Roads as the Road Standards for the Town
REVISED DATE:	PAGE NO.: 1 of 1
<u>PURPOSE AND INTENT</u> To establish a policy that adopts the information attached and provided by the Town's Engineers to indicate the Collector roads as the Road Standards for the Town of Chestermere.	
<u>POLICY</u> Road standards are based on the design vehicle trips per day for a particular roadway. Each housing unit creates 10 trips per day for a detached residential unit and 7 trips per day for a multi-family unit. The basic road standards are as follows: Residential road – 9.0m of pavement on a 15m right of way, 0 to 1000 trips per day Collector road – 11.5m pavement on a 21m right of way, 1000 to 7500 trips per day (example – East and West Chestermere Drive) Primary Collector – divided road, 2X7.0m on a 27m right of way, 7500 to 10,000 trips per day (example – entry gate road to Westmere, West Merganser future build out) Major Road – divided road, 2x7.6m on a 36m right of way, 10,000 to 30,000 trips per day (future Rainbow Road) The attached are the maps indicating the existing roads in Chestermere over and above the residential standard. Sections of the road standards noted are also provided.	

**Town of Chestermere Road Standards
2003**

May 01,

Road standards are based on the design vehicle trips per day for a particular roadway. Each housing unit creates 10 trips per day for a detached residential unit and 7 trips per day for a multi-family unit. The basic road standards are as follows:

Residential road – 9.0m of pavement on a 15m right of way, 0 to 1000 trips per day

Collector road – 11.5m pavement on a 21m right of way – 1000 to 7500 trips per day (example- East and West Chestermere Drive)

Primary Collector – divided road, 2X7.0m on a 27m right of way, 7500 to 10000 trips per day (example – entry gate road to Westmere, West Merganser future build out)

Major Road – divided road , 2X7.6m on a 36m right of way, 10,000 to 30,000 trips per day (future Rainbow Road)

The following map indicates the existing roads in Chestermere over and above the residential standard.

Sections of the road standards noted are also provided.

TOWN OF CHESTERMERE



Southland Taps & Associates, Inc.
 Planning Engineers & Surveyors
 1000 West 10th Street, Suite 100
 Denver, Colorado 80202
 Phone: (303) 733-1111
 Fax: (303) 733-1112

DATE: APRIL 1, 2008

SCALE: AS SHOWN

LEGEND

TOWN BOUNDARY
 COLLECTOR 11.5"/11
 81/20 RURAL SECTION
 PRIMARY COLLECTOR (UNDERS) 257/21
 MAJOR 227/18 OR 18

NOTES:
 1. ALL INFORMATION ON THIS PLAN IS BASED ON THE RECORDS OF THE TOWN OF CHESTERMERE AND THE RECORDS OF THE COLORADO DEPARTMENT OF REVENUE. THE TOWN OF CHESTERMERE IS A REGISTERED ALTA, P.L.C.
 2. ALL LEGAL RESPONSIBILITY FOR THIS MAP IS ASSIGNED TO THE ENGINEER OF RECORD.
 3. THE TOWN OF CHESTERMERE IS A REGISTERED ALTA, P.L.C.

1" = 100'

1" = 100'

1" = 100'

1" = 100'

1" = 100'

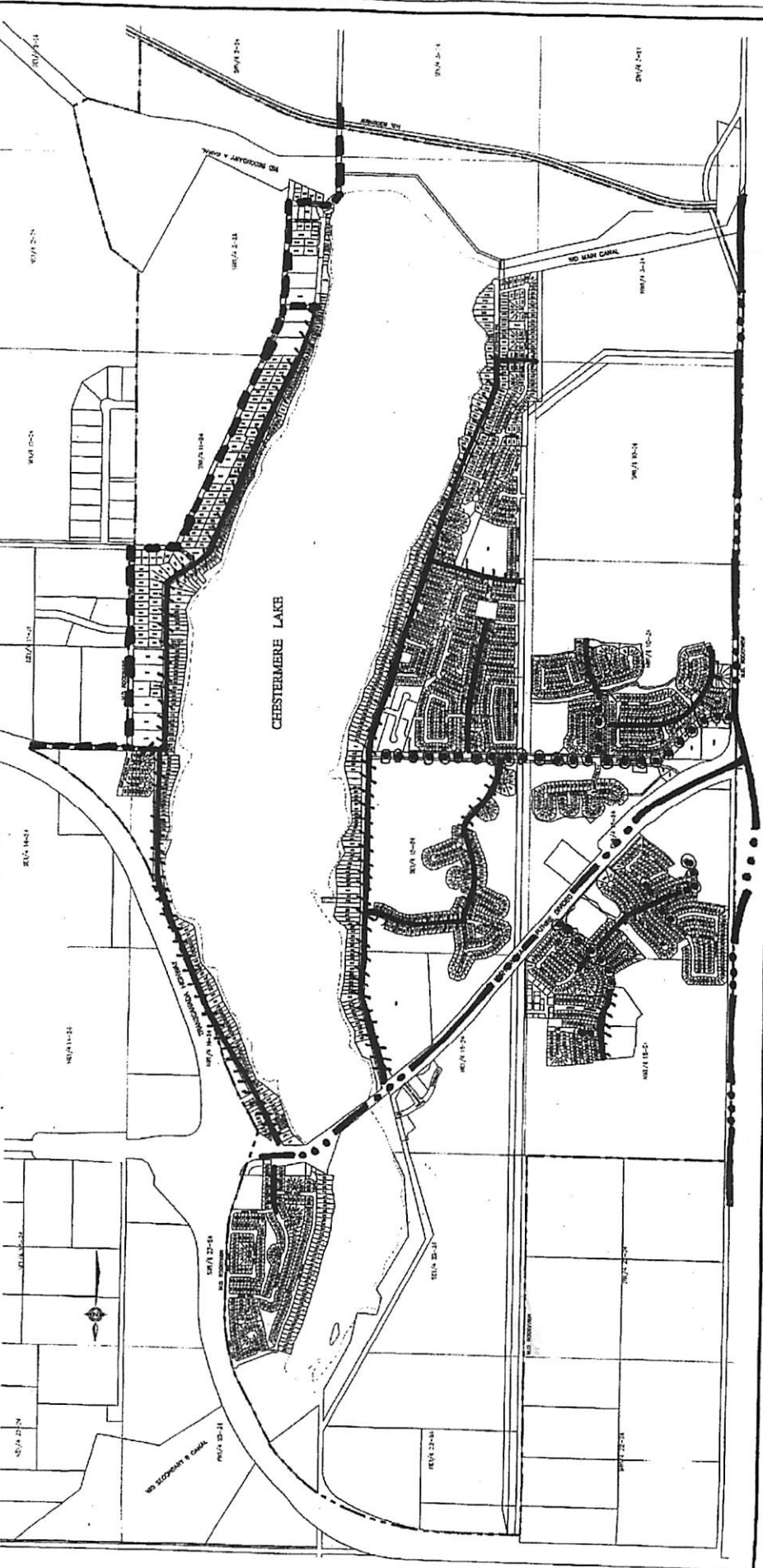

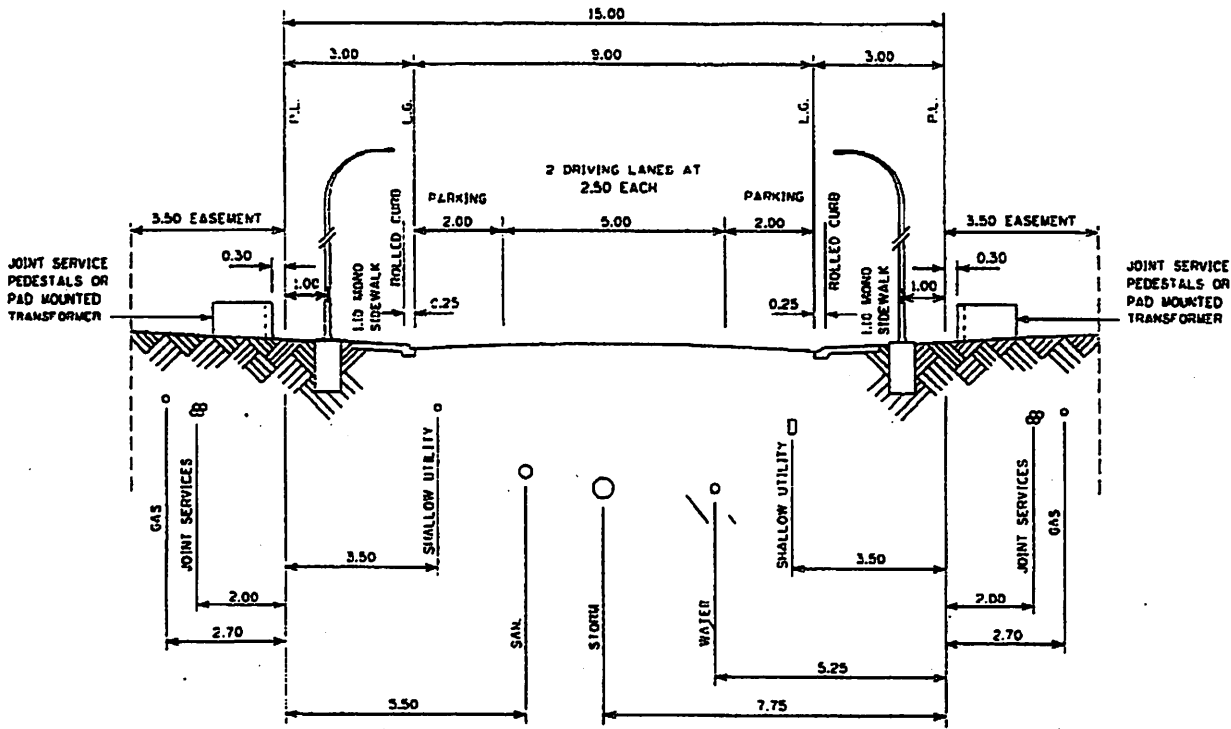

CARRIAGEWAY ALTERNATES

- A. CROWNED
- B. DISHED
- C. X-FALLED

NOTE: FOR CROWNED SECTION
CURB REQUIRED ON BOTH SIDES.

FOR DISHED SECTION
MINIMUM GRADE OF 1% REQUIRED
WITH MAXIMUM DRAINAGE LENGTH
OF 150.00.

FOR X-FALLED SECTION
CURB REQUIRED ON LOW SIDE.

- NOTE: - HYDRANT & SERVICE VALVES SHALL MAINTAIN A MIN. OF 2.50 SEPARATION TO THE CENTRE LINE OF POWER POLES & STREET LIGHTING POLES.
- HYDRANT & SERVICE VALVES SHALL MAINTAIN A MIN. OF 3.00 SEPARATION TO THE EDGE OF TRANSFORMER, PULL BOX / JUNCTION TERMINALS AND OTHER SURFACE STRUCTURES.
- NOTE: - HYDRANT ON 0.75 LINE.
- HYDRANT VALVES ON 4.25 LINE.
- SERVICE VALVES ON 0.50 LINE.
- PRE-INSTALLED SERVICE CONNECTIONS TO BE INSTALLED 3.50 INSIDE P.L. OR 5.00 INSIDE THE P.L. WHEN CROSSING GAS AND ONE OTHER SHALLOW UTILITY.
- ST. LT. CABLE CENTRED IN 1.50 EASEMENT WHERE THERE IS NO GAS EASEMENT.

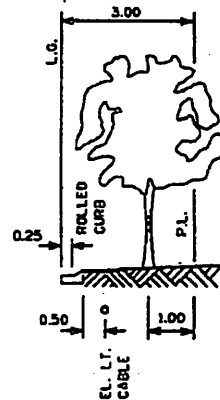

**ALTERNATIVE WITH
NO SIDEWALK**

**- ENVIRONMENTAL CAPACITY 1.000
VEHICLES PER DAY**

3	100 - 04	REVISE SHALLOW UTILITY O/S. CHANGE UTIL. COMPANY NAMES	10
4	BB - 10	CHANGE LABEL TO SHALLOW UTILITY	
3	95 - 03	ALTERNATIVE WITH NO SIDEWALK DETAIL ADDED	
2	95 - 03	NOTES REVISED	
1	95 - 03	NOTE ADDED	

Drawn J.T.R. Date 95 - 01
Scale: NTS
Approved for [Signature]
City Engineer

THE CITY OF CALGARY
RESIDENTIAL - PARKING
BOTH SIDES
15.00m R/W. 9.00m ROAD

METRIC
Sheet **5**
File Number 454.1008.039

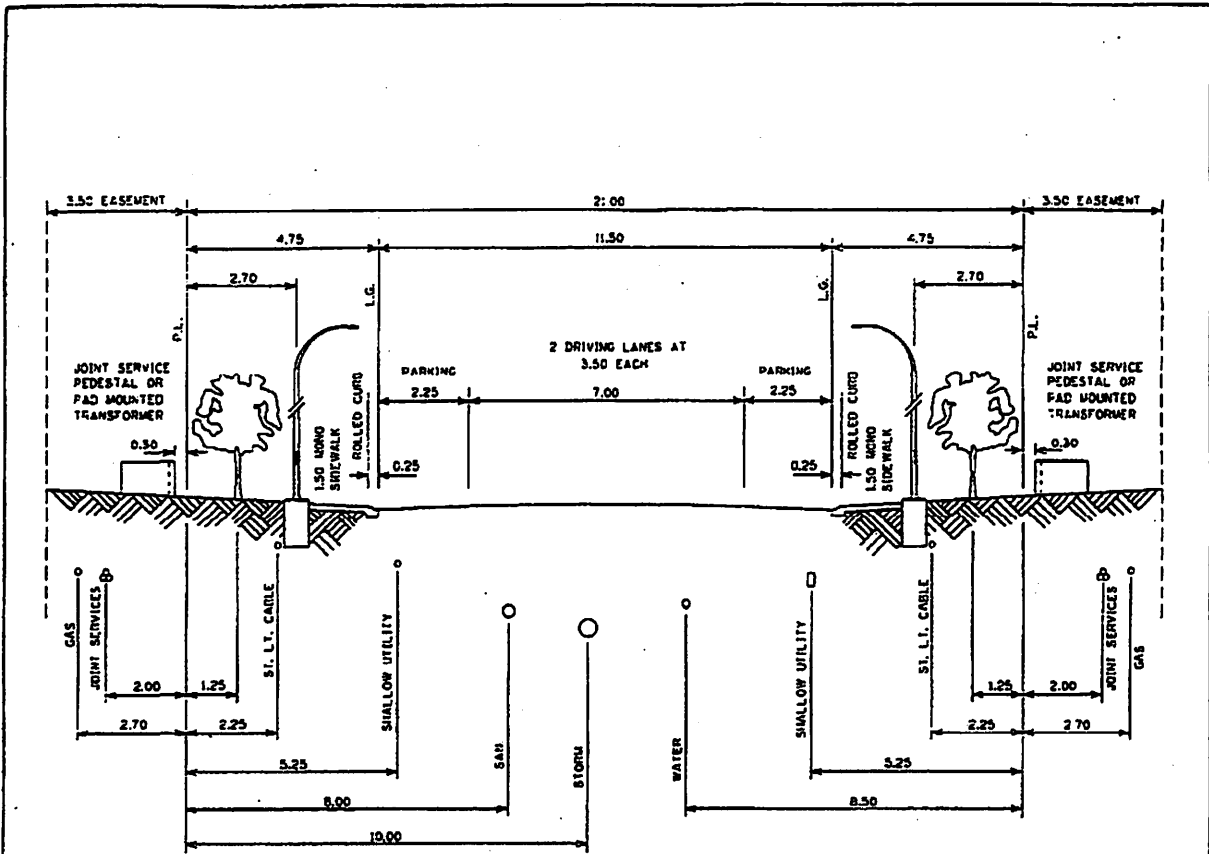

ALTERNATIVE WITH SEPARATE SIDEWALK

• SERVICE VALVES ON 2.50m LINE.

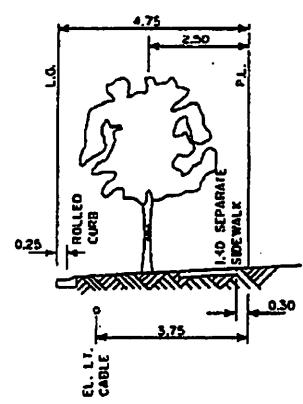

- NOTE:
- HYDRANTS ON 2.45 LINE.
 - HYDRANT VALVES ON 7.50 LINE.
 - SERVICE VALVES ON 1.25 LINE.
 - TREES ON 1.25 LINE.
 - PRE-INSTALLED SERVICE CONNECTIONS TO BE INSTALLED 3.50m INSIDE P.L. OR 5.00m INSIDE THE P.L. WHEN CROSSING GAS AND ONE OTHER SHALLOW UTILITY.
 - HYDRANT & SERVICE VALVES SHALL MAINTAIN A MIN. 2.50 SEPARATION TO THE CENTRE LINE OF POWER POLES & STREET LIGHTING POLES.
 - HYDRANT & SERVICE VALVES SHALL MAINTAIN A MIN. 3.00 SEPARATION TO THE EDGE OF TRANSFORMER.
 - PULL BOX / JUNCTION TERMINALS & OTHER SURFACE STRUCTURES.
 - ADDITIONAL SEPARATION MAY BE REQUIRED BETWEEN STORM & SANITARY SEWERS IF EXCESSIVE VERTICAL DIFFERENCE OCCURS.

- ENVIRONMENTAL CAPACITY 5.000 VEHICLES PER DAY

4 00 - 04 REVISE SHALLOW UTILITY O/S, CHANGE UTIL. COMPANY NAMES		Drawn J.T.R.	Date 95 - 01	THE CITY OF CALGARY COLLECTOR	Sheet 7
3 08 - 10 REVISE SHALLOW UTILITY O/S		Scale: MTS	Approved for:	PARKING BOTH SIDES 21.00m R/W, 11.50m ROAD	File Number 454.1008.040
2 05 - 05 REVISED NOTE & SEPARATION BETWEEN STORM & WATER		App'd:	Date:	PROJECT METRIC	
1 95 - 03 R.O.W. WIDTH REDUCED. NOTE ADDED & DETAIL DRAWING ADDED		No.	Date	Revision	

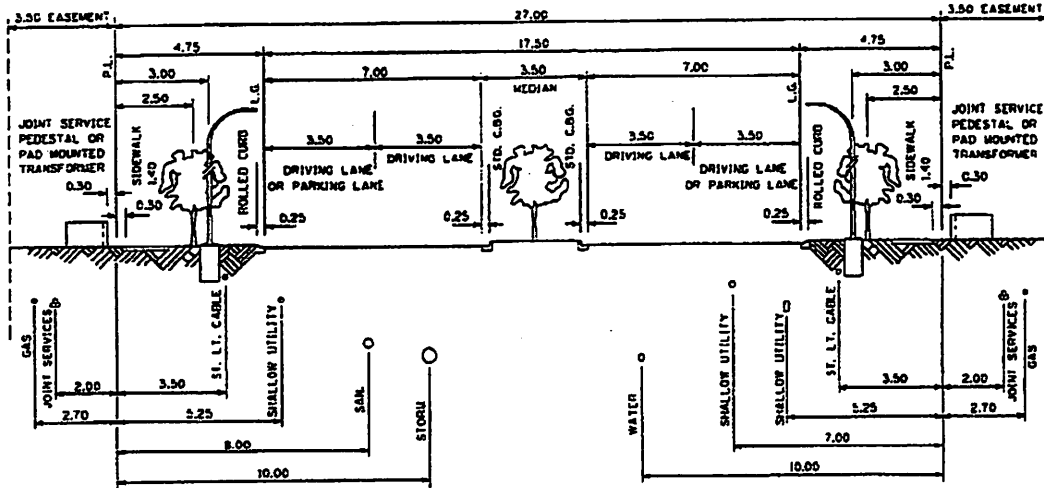

- NOTES -
- HYDRANTS ON 3.50 LINE.
 - HYDRANT VALVES ON 3.00 LINE.
 - SERVICE VALVES ON 2.50 LINE.
 - TREES ON 2.50 LINE IN BOULEVARD AND ON CENTRE LINE IN MEDIAN.
 - TREES SHALL BE SHALLOW ROOTED DECIDUOUS SPECIES AS APPROVED BY PARKS / RECREATION DEPARTMENT.
 - HYDRANT & SERVICE VALVES SHALL MAINTAIN A MIN. 2.50 SEPARATION TO THE CENTRE LINE OF POWER POLES & STREET LIGHTING POLES.
 - HYDRANT & SERVICE VALVES SHALL MAINTAIN A MIN. 3.00 SEPARATION TO THE EDGE OF TRANSFORMERS, PULL BOX / JUNCTION TERMINALS & OTHER SURFACE STRUCTURES.
 - WATER MAIN WILL BE INSTALLED ON THE OPPOSITE SIDE OF THE ROAD FROM SANITARY AND STORM LINES.
 - PRE-INSTALLED SERVICE CONNECTIONS TO BE INSTALLED 3.50 INSIDE P.L. OR 5.00 INSIDE THE P.L. WHEN CROSSING GAS AND ONE OTHER SHALLOW UTILITY.

- ENVIRONMENTAL CAPACITY 10,000 VEHICLES PER DAY

5 00 - 04 REVISE SHALLOW UTILITY O/S 4 98 - 10 REVISE SHALLOW UTILITY O/S 3 95 - 05 NOTE REVISED 2 95 - 03 LIP TO LIP DIMENSION REDUCED & NOTE ADDED 1 95 - 01 MEDIAN & R.O.W. REDUCED		Drawn J.T.R. Date 95 - 01 Scale MTS Approved for City Engineer	THE CITY OF CALGARY DEPARTMENT OF PUBLIC WORKS PRIMARY COLLECTOR 27.00m R/W. 2x7.00m ROAD	SHEET NO. 10 FILE NUMBER 454.1008.042
--	--	---	---	--

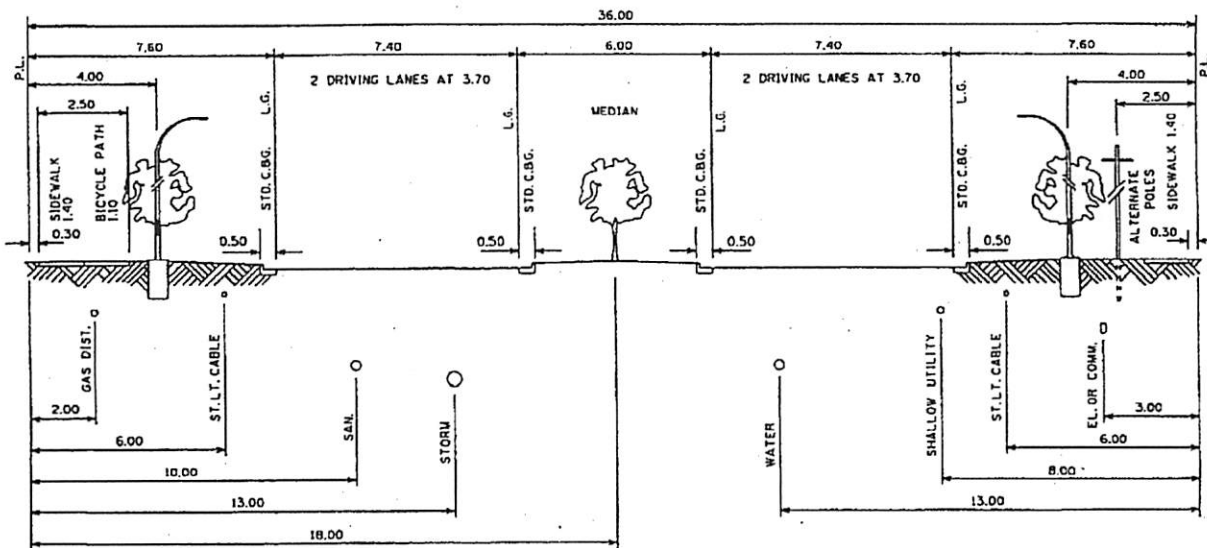

- NOTES:
- HYDRANTS ON 4.50 LINE.
 - HYDRANT VALVES ON 1.00 LINE FROM WATER MAIN.
 - SERVICE VALVES ON 4.00 LINE.
 - TREES ON 4.00 LINE IN BOULEVARD AND 18.00 LINE IN MEDIAN.
 - TREES SHALL BE OF A SPECIES AS APPROVED BY PARKS / RECREATION.
 - ALL TREES TO BE SHALLOW ROOT SPECIES.
 - POWER POLES, STREET LIGHT POLES, TRANSFORMER BOXES AND ALL OTHER SURFACE STRUCTURES SHALL MAINTAIN A MIN. OF 3.00m CLEARANCE FROM HYDRANT.
 - GAS FEEDER MAINS IN CARRIAGE WAY, DISTRIBUTION LINE IN BOULEVARD, OPPOSITE SIDE FROM OVERHEAD.
 - WATER MAIN WILL BE INSTALLED ON THE OPPOSITE SIDE OF THE ROAD FROM STORM & SAN. LINES.
 - PRE-INSTALLED SERVICE CONNECTIONS TO BE INSTALLED 3.50m INSIDE P.L. OR 5.00m INSIDE P.L. WHEN CROSSING GAS AND ONE OTHER SHALLOW UTILITY.
 - THIS STANDARD IS INTENDED AS A GUIDELINE FOR NEW DEVELOPMENT, WHERE NOT APPLICABLE MAKE ADJUSTMENTS AS REQUIRED.

			Drawn R.B.T.	Date JULY '94	 THE CITY OF CALGARY ENGINEERING & ENVIRONMENTAL SERVICES DEPARTMENT	Sheet 14
3	00-11	ADDED SIDEWALK/BICYCLE PATH DIMENSION	Scale: NTS	Approved for <i>[Signature]</i> City Engineer		DIVIDED MAJOR 36.00m R/W. 2x7.40m ROAD
2	00-04	REVISED UTILITY COMPANY NAMES				
1	98-10	REVISE SHALLOW UTILITY O/S				
No.	Date	Revision	App'd			